

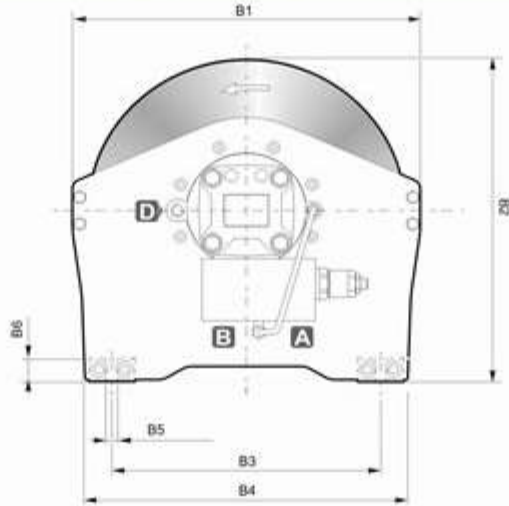

Kod / Tip Code / Type	Çekme Yüğü-Line Pull 1. sarm-4 sarm 1. winding-4 winding (daft)	Halat Boyu - 4 sarm Rope Capacity -4 winding (Düz Tambur-Smooth Drum) (m)	Halat Çapı Rope Diameter (mm)	Max. Sarma Hızı - 4 sarm Max. Rope Speed -4 winding (m/min.) (60 L/1')	Motor Deplasmanı Motor Displacement (cm <sup>3</sup> )	Max. Basınç Max. Pressure (bar)	Max. Debi Max. Flow (L/min.)
HP9-E	1600 - 1210	60	10	42	160	210	50
HS 19	2500 - 1900	60	12	47	200	210	75
HS 19/L*	2500 - 1900	90	12	47	200	210	75
HS 27/L	3660 - 2835	90	14	32	315	210	100
HS 27/XL	3660 - 2835	130	14	32	315	210	100

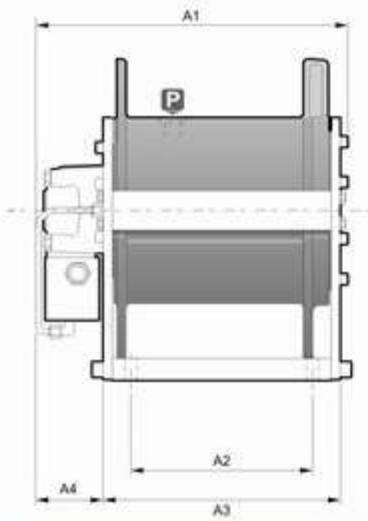

\*Düz veya Yivli Tambur  
Smooth or Grooved Drum

<b>A</b>	Kaldırma Girişi Hoisting Port	3/4"
<b>B</b>	İndirme Girişi Lowering Port	3/4"
<b>D</b>	Tahliye Girişi Drain Port	1/4"
<b>P</b>	Yağlama Tapası Lubrication Oil Plug	3/8"

Kod / Tip Code / Type	A1 (mm)	A2 (mm)	A3 (mm)	A4 (mm)	B1 (mm)	B2 (mm)	B3 (mm)	B4 (mm)	B5 (mm)	B6 (mm)
HP9-E	348	170	242	80	348	343	200	246	13	25
HS 19	370	196	287	80	375	348	290	348	13	25
HS 19/L	470	325	387	80	375	348	290	348	13	25
HS 27/L	515	310	402	83	470	436	360	425	15	30
HS 27/XL	595	435	512	83	470	436	360	425	15	30